

COMPRESSION TUBE FITTINGS PRODUCT CATALOG & PRICE LIST

UNIQUE FITTINGS

MOLDED FROM

FOUR

CORROSION-

RESISTANT

THERMORESINS

JACO

EFFECTIVE MARCH 2006



www.jacomfg.com

Plastic Fittings That Revolutionized The Techniques of Connecting Tubes.

JACO understands the needs of the plastics industry – from knowing how businesses operate to in-depth engineering design and applications.

For over 50 years, we have constantly looked for ways to make plastic parts better. And we've developed solutions in new technologies, equipment and products that have been solid contributors to industry.

JACO's innovative engineering, combined with our ability to produce precision plastic parts, led to the development of our compression fittings line.

Compression type metallic fittings have a loose ferrule which requires extra assembly. JACO has been able to mold the sleeve as an integral part of the nut, eliminating the need for a two-piece assembly. Although fittings were originally developed for copper tubing, other fittings were then later

engineered with plastic grippers for plastic tubing.

Today, JACO fittings are widely used with all types of tubing including copper, plastic, aluminum and glass.

JACO compression fittings typically cost less than metal fittings and they offer better resistance to corrosion and chemicals. Additionally, we offer four different plastic resins for a range of applications dealing with temperatures, acids and chemicals. JACO plastic fittings offer these additional advantages:

- ◆ Good electrical insulating qualities which eliminate electrolytic action that usually corrodes tubing when dissimilar metal meets a fitting.
- ◆ The ability to absorb mechanical and acoustical vibrations because of the low density and softness of plastic.

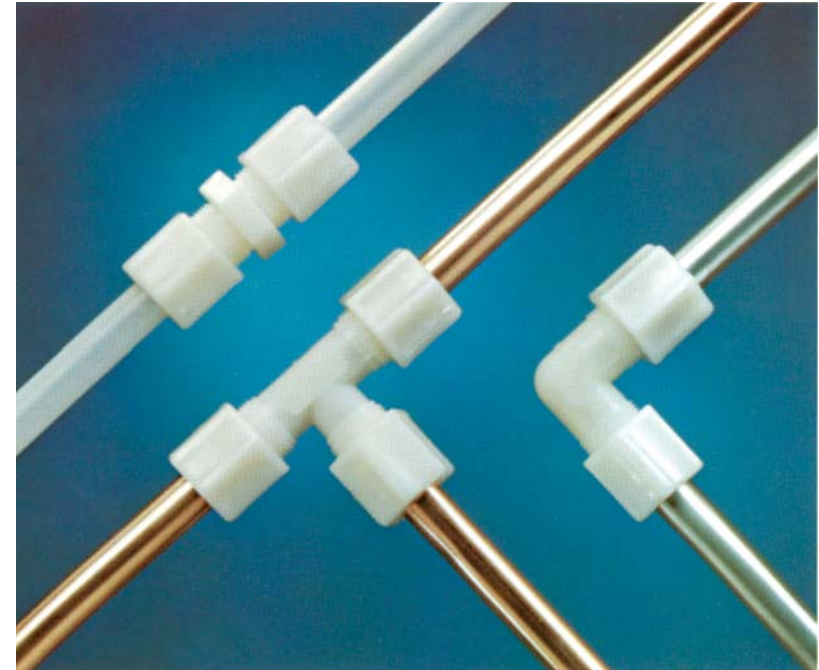

- ◆ An inherently low resistance to flow, due to smooth internal surface.
- ◆ A resistance to scale buildup. Fittings are available in size ranges from 1/8" through 7/8" tube O.D. in all common configurations, such as union, bulkhead, male and female connectors, male branch and male run tees,

tee unions and ferrule nuts. Metric sizes are also available on a special order basis.

Various resins are used, depending on the application. JACO plastic fittings are made of either nylon, acetal copolymer, polypropylene, or polyvinylidene fluoride.

CHEMICAL RESISTANCE OF JACO TUBE FITTINGS

How to Select Materials

(N) Nylon has good resistance to organic solvents, oils and gasoline. Good strength at high temperatures. Material rating: -40° to 200°F. Cold and hot-water applications. Longtime weathering resistance. Good impact resistance, both single and repeated. Not recommended for use with ammonium, boric acid, calcium, sulfuric acid, or hydrochloric acid. F.D.A. listed. Also N.S.F. listed.

(C) Celcon, or acetal copolymer, has high tensile strength and good impact resistance over a broad temperature range. Translucent white color. Not affected by continuous hot-water service and works smoothly with metal tubing. Celcon cannot be recommended for continuous exposure to solutions with a chlorine concentration greater than 1 ppm. Material is rated at -40° to 200°F in open air, and rated for 180°F in water applications. Unaffected by most inorganics, except sulfuric, nitric and hydrochloric acids. Listed by U.S.D.A. and F.D.A. for coffee, milk and antibiotics. Also N.S.F. listed. Should not be continuously exposed to sunlight.

(P) Polypropylene has good chemical resistance. Material is rated at -30 to 215°. Opaque, white color. Unaffected by most weak acids and alkalis. Below 175°F it has good resistance to organic solvents. Do not use with oxidants or strong acids or in continuous sunlight. N.S.F. listed. 20% glass filled for improved stiffness.

(K) Kynar, a polyvinylidene fluoride, has outstanding chemical resistance for handling highly corrosive fluids. Material rated at -80 to 275°, with a cloudy, white color. F.D.A. listed, N.S.F. Listed.

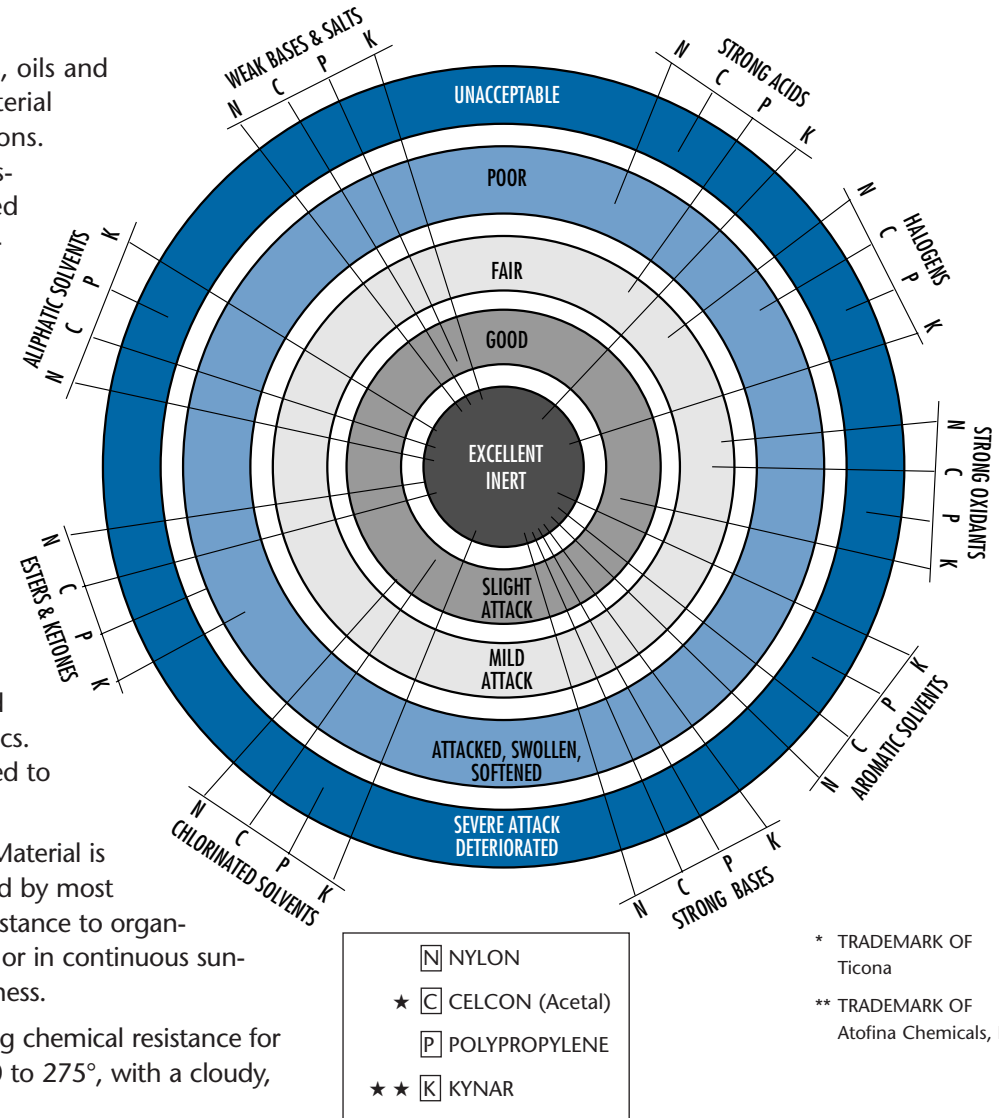

Operating temperatures of JACO Tube Fittings are regulated by ambient and fluid temperatures, type of fluid being carried, tubing type, and conditions of mechanical abuse. Temperatures listed are designated as material ratings only. Testing of complete fitting in customer application is recommended.

440-234-4000 Phone
800-229-JACO Toll-Free
440-234-7007 Fittings Fax
www.jacomfg.com

HOW TO ORDER JACO TUBE COMPRESSION FITTINGS

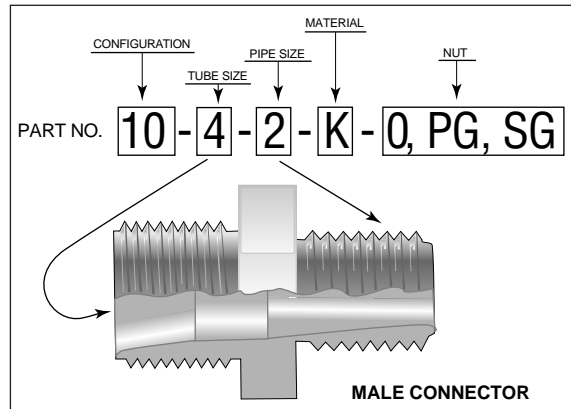

The part number for JACO compression Fittings is designed so that each number and letter immediately identifies the shape, size and material.

For example: the first number identifies the shape, I.E.
10 = Male Connector,
25 = Female Connector,
50 = Union Elbow, etc.

The second number designates the tube size, in 1/16" increments, I.E.
4 = 1/4" O.D. Tubing,
8 = 1/2" O.D. Tubing.

The third number, also in 1/16" increments, (unless a Union type fitting is required), designates the pipe size.

The letter following the numbers indicates the material:

- K = Kynar
- N = Nylon
- P = Polypropylene
- C = Celcon

The last letter(s) denote the nut desired:

- O = Standard - *50 P.S.I.
- P.G. = Plastic Gripper for plastic tubing - *220 P.S.I.
- S.G. = Stainless Steel Gripper for use with hard surfaced tubing - *220 P.S.I.

It is not necessary to designate the nut size when ordering complete units as this will be determined by the tube size indication in the part number.

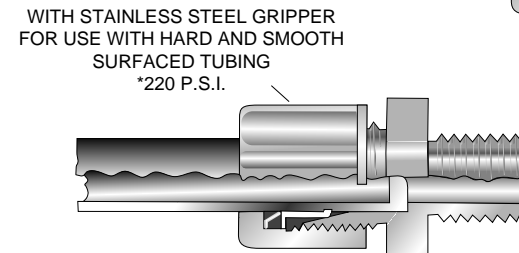
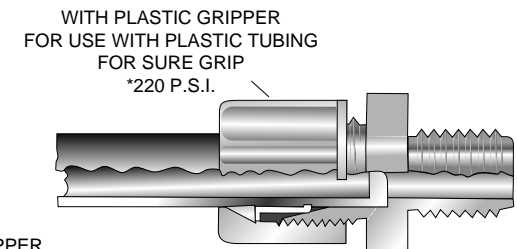
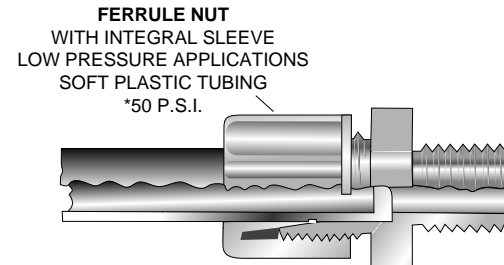

Note: Fitting dimensions as described in this brochure may not reflect running changes made to improve part performance. Check with JACO Manufacturing Company in critical applications.

*Operating pressures of JACO Tube Fittings are regulated by ambient and fluid temperatures, type of fluid being carried, tubing type, and conditions of mechanical abuse. Pressures in excess of above specifications in all fitting sizes should be tested by the customer in their particular application.

Visit our Web Page:
www.jacomfg.com
 for the following information:

- Latest Part Information
- List of our Current Authorized Distributors
- Standard Pack Information

Terms

Prices subject to change without notice.
 Fittings are priced as complete units.
 Ordering Nuts and Bodies separately will not raise quantity to higher discount schedule.

Pricing is based on per order per release.
 Discounts apply only to pack quantities.

TERMS: NET 30 Days

FREIGHT: F.O.B. Berea, Ohio U.S.A.

MINIMUM ORDER U.S.A. \$100.00 NET; FOREIGN \$150.00 NET

DISCOUNTS APPLY ONLY IF INVOICE TERMS ARE MET.

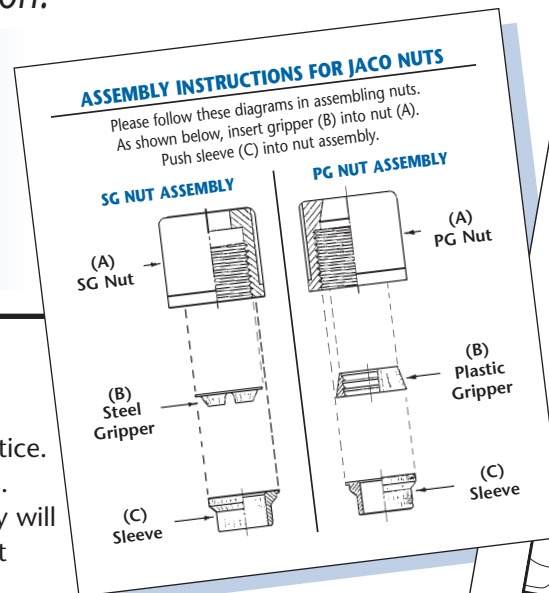

INSTALLATION INSTRUCTIONS FOR JACO TUBE FITTINGS

1. Cut the tubing end squarely and remove the internal and external burrs.
2. Insert the tubing through the back of the nut all the way through the nut assembly to the tube stop in the fitting body (see illustration). If the tubing does not enter the nut easily, loosen the nut one turn and then insert the tubing all the way to the tube stop in the fitting body.
3. Turn the nut hand tight.
4. Wrench tighten the nut 1-1/2 - 2 turns.
5. All nuts must be retightened when the system reaches projected operating temperature.

NOTE: Squeaking sound when tightening nut is normal. For pipe threaded connections, Teflon Tape* must be used.

*Dupont's Reg. T.M. Patent 1983

Ferrule Nut **Fitting Body**

Tube **Tube Stop**

Caution: To insure proper assembly, tubing **MUST** be fully inserted into the fitting body to the tube stop.

NOTE: It is not necessary to disassemble this fitting for application. Merely insert tubing to stop and tighten nut.

10

MALE CONNECTORS

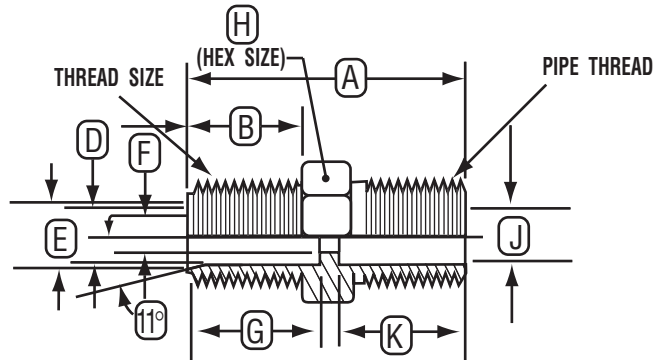
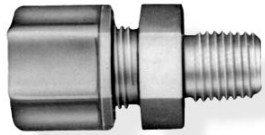

| JACO Part No. Prefix |
|----------------------|
| 10-2-2 |
| 10-4-2 |
| 10-4-4 |
| 10-4-6 |
| 10-5-2 |
| 10-5-4 |
| 10-6-2 |
| 10-6-4 |
| 10-6-6 |
| 10-6-8 |
| 10-8-2 |
| 10-8-4 |
| 10-8-6 |
| 10-8-8 |
| 10-10-6 |
| 10-10-8 |
| 10-12-8 |
| 10-12-12 |
| 10-14-12 |

| LIST PRICE | | | |
|----------------------|------------------------------|---------|---------|
| Standard Ferrule Nut | Plastic or Steel Gripper Nut | | |
| NYLON (N-O) | KYNAR | N-PG:SG | KYNAR |
| CELCON (C-O) | (K-O) | C-PG:SG | K-PG:SG |
| POLY (P-O) | | P-PG:SG | |
| .43 | 2.28 | N/A | N/A |
| .49 | 2.61 | .63 | 2.73 |
| .54 | 2.74 | .67 | 2.85 |
| .56 | 3.25 | .69 | 3.36 |
| .57 | 2.89 | .68 | 3.01 |
| .59 | 2.96 | .70 | 3.08 |
| .64 | 4.01 | .80 | 4.06 |
| .65 | 4.13 | .81 | 4.18 |
| .73 | 4.31 | .89 | 4.36 |
| .89 | 4.89 | 1.04 | 4.94 |
| 1.11 | 4.50 | 1.29 | 4.55 |
| 1.14 | 5.48 | 1.33 | 5.53 |
| .89 | 4.94 | 1.08 | 4.99 |
| .95 | 5.27 | 1.14 | 5.32 |
| N/A | N/A | 1.24 | 6.31 |
| N/A | N/A | 1.26 | 6.58 |
| N/A | N/A | 2.08 | 9.28 |
| N/A | N/A | 2.16 | 9.57 |
| N/A | N/A | 2.39 | 10.50 |

| SPECIFICATIONS | | | | | | | | | | | |
|----------------|-----------|-----------|---------|--------|-----------------|--------------|--------|--------|--------|--------|--------|
| Tube O.D. | Pipe Thd. | Thread | A | B | D | E | F | G | H | J | K |
| | | | ± 1/64 | ± 1/64 | + .005 /.010 | | ± .010 | ± 1/64 | ± 1/64 | ± 1/64 | ± 1/64 |
| 1/8 | 1/8 | 5/16-24 | 7/8 | 5/16 | .125 | .175 - .180 | .109 | 7/16 | 7/16 | 15/64 | 25/64 |
| 1/4 | 1/8 | 7/16-20 | 63/64 | 3/8 | .250 | .330 - .335 | .170 | 15/32 | 5/8 | 3/16 | 15/32 |
| 1/4 | 1/4 | 7/16-20 | 1-3/16 | 11/32 | .250 | .330 - .335 | .170 | 15/32 | 5/8 | 5/16 | 11/16 |
| 1/4 | 3/8 | 7/16-20 | 1-13/64 | 3/8 | .250 | .330 - .335 | .170 | 15/32 | 13/16 | 3/8 | 43/64 |
| 5/16 | 1/8 | 1/2-20 | 1 | 3/8 | .312 | .380 - .385 | .250 | 31/64 | 11/16 | 1/4 | Thru |
| 5/16 | 1/4 | 1/2-20 | 1-3/16 | 3/8 | .312 | .380 - .385 | .232 | 31/64 | 11/16 | 5/16 | 41/64 |
| 3/8 | 1/8 | 5/8-20 | 1-9/64 | 15/32 | .375 | .460 - .465 | .250 | 19/32 | 13/16 | 1/4 | Thru |
| 3/8 | 1/4 | 5/8-20 | 1-5/16 | 29/64 | .375 | .460 - .465 | .312 | 19/32 | 13/16 | 5/16 | Thru |
| 3/8 | 3/8 | 5/8-20 | 1-11/32 | 29/64 | .375 | .460 - .465 | .250 | 19/32 | 13/16 | 3/8 | 23/32 |
| 3/8 | 1/2 | 5/8-20 | 1-19/32 | 15/32 | .375 | .460 - .465 | .250 | 19/32 | 15/16 | 15/32 | 15/16 |
| 1/2 | 1/8 | 3/4-20 | 1-15/64 | 9/16 | .500 | .590 - .595 | .250 | 11/16 | 15/16 | 1/4 | Thru |
| 1/2 | 1/4 | 3/4-20 | 1-27/64 | 9/16 | .500 | .590 - .595 | .312 | 11/16 | 15/16 | 5/16 | Thru |
| 1/2 | 3/8 | 3/4-20 | 1-15/32 | 9/16 | .500 | .590 - .595 | .375 | 11/16 | 15/16 | 3/8 | Thru |
| 1/2 | 1/2 | 3/4-20 | 1-5/8 | 9/16 | .500 | .590 - .595 | .375 | 11/16 | 15/16 | 15/32 | 57/64 |
| 5/8 | 3/8 | 7/8-20 | 1-31/64 | 19/32 | .625 | .715 - .720 | .375 | 45/64 | 1-1/16 | 3/8 | Thru |
| 5/8 | 1/2 | 7/8-20 | 1-5/8 | 19/32 | .625 | .715 - .720 | .484 | 45/64 | 1-1/16 | 31/64 | Thru |
| 3/4 | 1/2 | 1-1/16-20 | 1-51/64 | 43/64 | .750 | .860 - .865 | .500 | 13/16 | 1-5/16 | 1/2 | Thru |
| 3/4 | 3/4 | 1-1/16-20 | 1-5/16 | 43/64 | .750 | .860 - .865 | .625 | 13/16 | 1-5/16 | 5/8 | Thru |
| 7/8 | 3/4 | 1-3/16-16 | 2 | 3/4 | .875 | .995 - 1.000 | .625 | 7/8 | 1-7/16 | 5/8 | Thru |

N = NYLON C = CELCON (Acetal)
 P = POLYPROPYLENE
 K = KYNAR (Polyvinylidene Fluoride)

Sizes indicated are based on Celcon material (Acetal).

440-234-4000 Phone
 800-229-JACO Toll-Free
 440-234-7007 Fittings Fax
 www.jacomfg.com

15

UNION & REDUCING UNION CONNECTORS

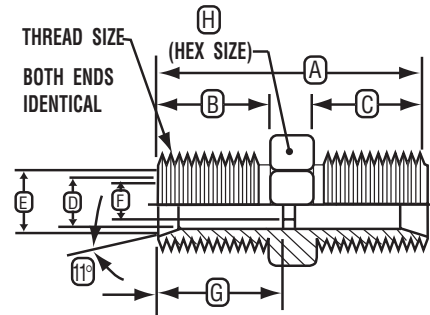
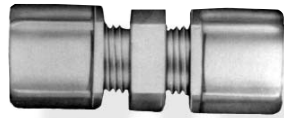

Union Connectors

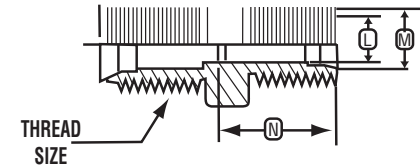

Reducing Unions

UNION CONNECTORS

| JACO Part No. | LIST PRICE | | | |
|---------------|----------------------|------|------------------------------|-------|
| | Standard Ferrule Nut | | Plastic or Steel Gripper Nut | |
| 15-4 | .73 | 3.52 | 1.00 | 3.74 |
| 15-5 | .82 | 4.23 | 1.04 | 4.47 |
| 15-6 | 1.03 | 5.94 | 1.35 | 6.04 |
| 15-8 | 1.35 | 7.47 | 1.72 | 7.57 |
| 15-10 | N/A | N/A | 2.00 | 9.33 |
| 15-12 | N/A | N/A | 3.22 | 12.04 |
| 15-14 | N/A | N/A | 3.73 | 13.83 |

| SPECIFICATIONS | | | | | | | | |
|----------------|-----------|---------|--------|----------------|--------------|--------|--------|--------|
| Tube O.D. | Thread | A | B | D | E | F | G | H |
| | | ± 1/64 | ± 1/64 | +.005/ .010 | | ± .010 | ± 1/64 | ± 1/64 |
| 1/4 | 7/16-20 | 63/64 | 3/8 | .250 | .330 - .335 | .170 | 15/32 | 5/8 |
| 5/16 | 1/2-20 | 1-1/32 | 25/64 | .312 | .380 - .385 | .232 | 31/64 | 11/16 |
| 3/8 | 5/8-20 | 1-15/64 | 15/32 | .375 | .460 - .465 | .250 | 19/32 | 13/16 |
| 1/2 | 3/4-20 | 1-7/16 | 9/16 | .500 | .590 - .595 | .375 | 11/16 | 15/16 |
| 5/8 | 7/8-20 | 1-1/2 | 19/32 | .625 | .715 - .720 | .500 | 45/64 | 1-1/16 |
| 3/4 | 1-1/16-20 | 1-3/4 | 43/64 | .750 | .860 - .865 | .625 | 13/16 | 1-5/16 |
| 7/8 | 1-3/16-16 | 1-57/64 | 3/4 | .875 | .995 - 1.000 | .750 | 7/8 | 1-7/16 |

REDUCING UNIONS

| JACO Part No. | LIST PRICE | | | |
|---------------|----------------------|------|------------------------------|-------|
| | Standard Ferrule Nut | | Plastic or Steel Gripper Nut | |
| 15-4-2 | .73 | 3.23 | N/A | N/A |
| 15-5-4 | .78 | 3.68 | 1.03 | 3.91 |
| 15-6-4 | .95 | 4.96 | 1.24 | 5.12 |
| 15-8-6 | 1.20 | 7.08 | 1.54 | 7.18 |
| 15-10-6 | N/A | N/A | 1.81 | 8.18 |
| 15-10-8 | N/A | N/A | 1.96 | 8.68 |
| 15-14-10 | N/A | N/A | 3.57 | 12.93 |

| SPECIFICATIONS | | | | | | | | | | | | | |
|----------------|-----------|---------|---------|--------|--------|----------------|--------------|--------|--------|--------|--------|-------------|--------|
| Tube O.D. | Thd. | Thread | A | B | C | D | E | F | G | H | L | M | N |
| | | | ± 1/64 | ± 1/64 | ± 1/64 | +.005/ .010 | | ± 1/64 | ± 1/64 | ± 1/64 | ± 1/64 | ± 1/64 | ± 1/64 |
| 1/4 - 1/8 | 7/16-20 | 5/16-24 | 59/64 | 3/8 | 5/16 | .250 | .330 - .335 | .109 | 15/32 | 5/8 | .125 | .175 - .180 | 7/16 |
| 5/16 - 1/4 | 1/2-20 | 7/16-20 | 1 | 3/8 | 3/8 | .312 | .380 - .385 | .170 | 31/64 | 11/16 | .250 | .330 - .335 | 15/32 |
| 3/8 - 1/4 | 5/8-20 | 7/16-20 | 1-3/16 | 29/64 | 29/64 | .375 | .460 - .465 | .170 | 19/32 | 13/16 | .250 | .330 - .335 | 15/32 |
| 1/2 - 3/8 | 3/4-20 | 5/8-20 | 1-5/16 | 9/16 | 29/64 | .500 | .590 - .595 | .250 | 11/16 | 15/16 | .375 | .460 - .465 | 19/32 |
| 5/8 - 3/8 | 7/8-20 | 5/8-20 | 1-23/64 | 19/32 | 15/32 | .625 | .715 - .720 | .250 | 45/64 | 1-1/16 | .375 | .460 - .465 | 19/32 |
| 5/8 - 1/2 | 7/8-20 | 3/4-20 | 1-15/32 | 19/32 | 9/16 | .625 | .715 - .720 | .375 | 45/64 | 1-1/16 | .500 | .590 - .595 | 11/16 |
| 7/8 - 5/8 | 1-3/16-16 | 7/8-20 | 1-21/32 | 3/4 | 17/32 | .875 | .995 - 1.000 | .500 | 7/8 | 1-7/16 | .625 | .715 - .720 | 45/64 |

N = NYLON C = CELCON (Acetal)
P = POLYPROPYLENE
K = KYNAR (Polyvinylidene Fluoride)

Sizes indicated are based on Celcon material (Acetal).

440-234-4000 Phone
800-229-JACO Toll-Free
440-234-7007 Fittings Fax
www.jacomfg.com

20

BULKHEAD UNIONS

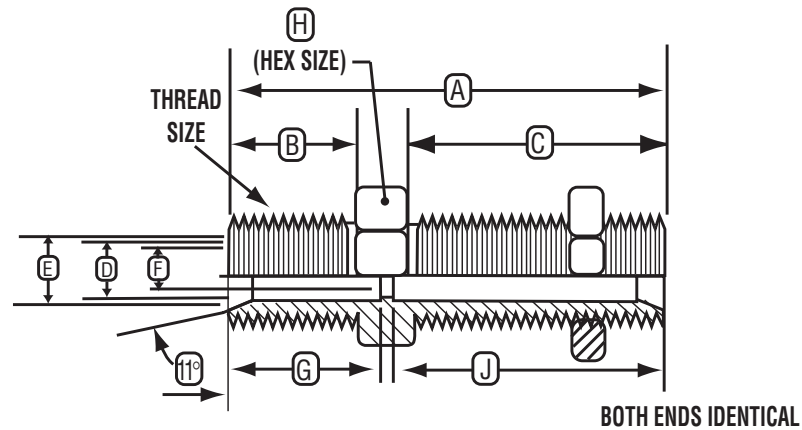

| JACO Part No. | LIST PRICE | | | | SPECIFICATIONS | | | | | | | | | | |
|------------------|----------------------|-------|------------------------------|---------|----------------|-----------|---------|-------|---------|--------|-------------|------|-------|--------|---------|
| | Standard Ferrule Nut | | Plastic or Steel Gripper Nut | | Tube O.D. | Thread | A | B | C | D | E | F | G | H | J |
| | NYLON (N-O) | KYNAR | N-PG;SG | KYNAR | | | | | | +.005/ | | | | | |
| | CELCON (C-O) | (K-O) | C-PG;SG | K-PG;SG | | | | | | | | | | | |
| | POLY (P-O) | | P-PG;SG | | | | | | | | | | | | |
| 20-4 | 1.08 | 4.82 | 1.35 | 5.04 | 1/4 | 7/16-20 | 1-31/64 | 23/64 | 7/8 | .250 | .330 - .335 | .170 | 15/32 | 5/8 | 31/32 |
| 20-5 | 1.17 | 5.25 | 1.40 | 5.50 | 5/16 | 1/2-20 | 1-5/8 | 23/64 | 63/64 | .312 | .380 - .385 | .232 | 31/64 | 11/16 | 1-3/32 |
| 20-6 | 1.39 | 7.71 | 1.70 | 7.81 | 3/8 | 5/8-20 | 1-49/64 | 29/64 | 1-1/64 | .375 | .460 - .465 | .250 | 19/32 | 13/16 | 1-1/8 |
| 20-8 | 1.86 | 8.89 | 2.23 | 8.99 | 1/2 | 3/4-20 | 1-7/8 | 35/64 | 1-3/64 | .500 | .590 - .595 | .375 | 11/16 | 15/16 | 1-9/64 |
| 20-12 | N/A | N/A | 3.88 | 13.56 | 3/4 | 1-1/16-20 | 2-13/64 | 43/64 | 1-11/32 | .750 | .860 - .865 | .625 | 13/16 | 1-5/16 | 1-15/32 |

N = NYLON C = CELCON (Acetal)
 P = POLYPROPYLENE
 K = KYNAR (Polyvinylidene Fluoride)

Sizes indicated are based on Celcon material (Acetal).

440-234-4000 Phone
 800-229-JACO Toll-Free
 440-234-7007 Fittings Fax
 www.jacomfg.com

25

FEMALE CONNECTORS

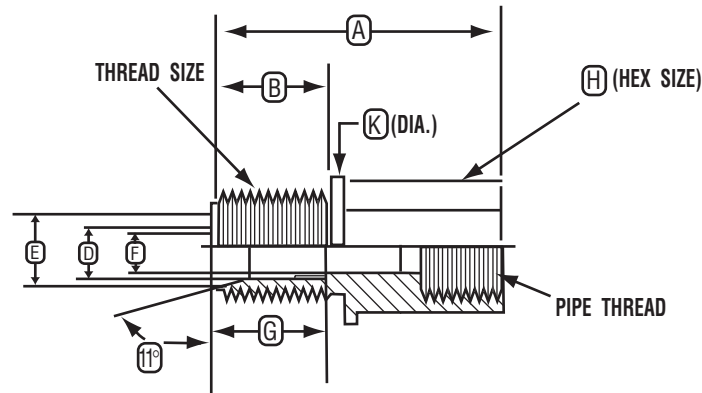
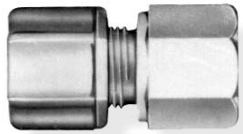

| JACO Part No. | LIST PRICE | | | |
|------------------|----------------------|-------|------------------------------|---------|
| | Standard Ferrule Nut | | Plastic or Steel Gripper Nut | |
| | NYLON (N-O) | KYNAR | N-PG;SG | KYNAR |
| | CELCON (C-O) | (K-O) | C-PG;SG | K-PG;SG |
| | POLY (P-O) | | P-PG;SG | |
| 25-4-2 | .66 | 2.61 | .80 | 2.73 |
| 25-4-4 | .69 | 2.84 | .83 | 2.95 |
| 25-5-4 | .75 | 3.07 | .87 | 3.19 |
| 25-6-4 | .84 | 4.13 | .99 | 4.18 |
| 25-6-6 | .87 | 4.18 | 1.02 | 4.23 |
| 25-6-8 | 1.00 | 4.76 | 1.16 | 4.81 |
| 25-8-6 | .99 | 4.84 | 1.18 | 4.89 |
| 25-8-8 | 1.07 | 5.15 | 1.25 | 5.20 |
| 25-10-8 | N/A | N/A | 1.94 | 6.09 |

| SPECIFICATIONS | | | | | | | | | | |
|----------------|-----------|---------|---------|--------|------|-------------|--------|--------|--------|--------|
| Tube O.D. | Pipe Thd. | Thread | A | B | D | E | F | G | H | K |
| | | | ± 1/64 | ± 1/64 | .010 | | ± .010 | ± 1/64 | ± 1/64 | ± 1/64 |
| 1/4 | 1/8 | 7/16-20 | 59/64 | 23/64 | .250 | .330 - .335 | .170 | 15/32 | 43/64 | 25/64 |
| 1/4 | 1/4 | 7/16-20 | 1-3/32 | 3/8 | .250 | .330 - .335 | .170 | 15/32 | 51/64 | 29/32 |
| 5/16 | 1/4 | 1/2-20 | 1-7/32 | 15/32 | .312 | .380 - .385 | .232 | 31/64 | 3/4 | 13/16 |
| 3/8 | 1/4 | 5/8-20 | 1-13/64 | 29/64 | .375 | .460 - .465 | .250 | 9/16 | 3/4 | 13/16 |
| 3/8 | 3/8 | 5/8-20 | 1-7/32 | 15/32 | .375 | .460 - .465 | .250 | 19/32 | 15/16 | N/A |
| 3/8 | 1/2 | 5/8-20 | 1-17/64 | 15/32 | .375 | .460 - .465 | .250 | 19/32 | 1-1/16 | N/A |
| 1/2 | 3/8 | 3/4-20 | 1-9/32 | 39/64 | .500 | .590 - .595 | .375 | 11/16 | 15/16 | N/A |
| 1/2 | 1/2 | 3/4-20 | 1-9/32 | 9/16 | .500 | .590 - .595 | .375 | 11/16 | 1-1/16 | N/A |
| 5/8 | 1/2 | 7/8-20 | 1-1/2 | 11/16 | .625 | .715 - .720 | .500 | 45/64 | 1-1/16 | N/A |

N = NYLON C = CELCON (Acetal)
 P = POLYPROPYLENE
 K = KYNAR (Polyvinylidene Fluoride)

Sizes indicated are based on Celcon material (Acetal).

440-234-4000 Phone
800-229-JACO Toll-Free
440-234-7007 Fittings Fax
www.jacomfg.com

40

MALE ELBOWS

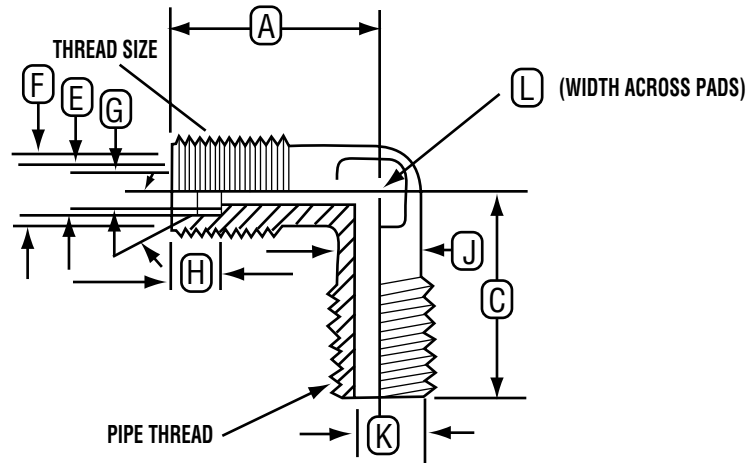

| JACO Part No. | LIST PRICE | | | |
|------------------|----------------------|-------|------------------------------|---------|
| | Standard Ferrule Nut | | Plastic or Steel Gripper Nut | |
| | NYLON (N-0) | KYNAR | N-PG;SG | KYNAR |
| | CELCON (C-0) | (K-0) | C-PG;SG | K-PG;SG |
| | POLY (P-0) | | P-PG;SG | |
| 40-2-2 | .75 | 2.60 | N/A | N/A |
| 40-4-2 | .77 | 2.77 | .91 | 2.88 |
| 40-4-4 | .78 | 2.84 | .92 | 2.95 |
| 40-4-6 | .93 | 4.30 | 1.07 | 4.41 |
| 40-5-2 | .87 | 3.02 | .98 | 3.14 |
| 40-5-4 | .88 | 3.22 | .99 | 3.34 |
| 40-6-4 | .98 | 4.23 | 1.14 | 4.28 |
| 40-6-6 | 1.02 | 4.31 | 1.18 | 4.36 |
| 40-8-4 | 1.09 | 4.97 | 1.27 | 5.02 |
| 40-8-6 | 1.18 | 5.04 | 1.37 | 5.09 |
| 40-8-8 | 1.19 | 5.59 | 1.38 | 5.64 |
| 40-10-6 | N/A | N/A | 1.61 | 6.54 |
| 40-10-8 | N/A | N/A | 1.66 | 6.53 |

| SPECIFICATIONS | | | | | | | | | | | |
|----------------|-----------|---------|---------|---------|-----------------|-------------|--------|--------|--------|--------|--------|
| Tube O.D. | Pipe Thr. | Thread | A | C | E | F | G | H | J | K | L |
| | | | ± 1/64 | ± 1/64 | + .005 /.010 | | ± .010 | ± 1/64 | ± 1/64 | ± 1/64 | ± 1/64 |
| 1/8 | 1/8 | 5/16-24 | 9/16 | 5/8 | .125 | .175 - .180 | .109 | 7/16 | 1/4 | 13/16 | 1/4 |
| 1/4 | 1/8 | 7/16-20 | 13/16 | 13/16 | .250 | .330 - .335 | .170 | 15/32 | 3/8 | .250 | 3/8 |
| 1/4 | 1/4 | 7/16-20 | 13/16 | 1-1/64 | .250 | .330 - .335 | .218 | 15/32 | 3/8 | 9/32 | 3/8 |
| 1/4 | 3/8 | 7/16-20 | 55/64 | 1-1/32 | .250 | .330 - .335 | .218 | 15/32 | 35/64 | 3/8 | 35/64 |
| 5/16 | 1/8 | 1/2-20 | 29/32 | 29/32 | .312 | .380 - .385 | .232 | 31/64 | 7/16 | 1/4 | 7/16 |
| 5/16 | 1/4 | 1/2-20 | 29/32 | 1-5/64 | .312 | .380 - .385 | .232 | 31/64 | 7/16 | 1/4 | 7/16 |
| 3/8 | 1/4 | 5/8-20 | 15/16 | 1-1/32 | .375 | .460 - .465 | .250 | 19/32 | 37/64 | 5/16 | 37/64 |
| 3/8 | 3/8 | 5/8-20 | 15/16 | 1-1/32 | .375 | .460 - .465 | .250 | 19/32 | 9/16 | 3/8 | 9/16 |
| 1/2 | 1/4 | 3/4-20 | 1-3/32 | 1-1/8 | .500 | .590 - .595 | .375 | 11/16 | 11/16 | 5/16 | 11/16 |
| 1/2 | 3/8 | 3/4-20 | 1-5/64 | 1-1/8 | .500 | .590 - .595 | .375 | 11/16 | 11/16 | 3/8 | 11/16 |
| 1/2 | 1/2 | 3/4-20 | 1-1/16 | 1-1/4 | .500 | .590 - .595 | .375 | 11/16 | 11/16 | 3/8 | 11/16 |
| 5/8 | 3/8 | 7/8-20 | 1-17/64 | 1-17/64 | .625 | .715 - .720 | .500 | 45/64 | 13/16 | 3/8 | 55/64 |
| 5/8 | 1/2 | 7/8-20 | 1-9/32 | 1-29/64 | .625 | .715 - .720 | .500 | 45/64 | 13/16 | 1/2 | 55/64 |

N = NYLON C = CELCON (Acetal)
 P = POLYPROPYLENE
 K = KYNAR (Polyvinylidene Fluoride)

Sizes indicated are based on Celcon material (Acetal).

440-234-4000 Phone
 800-229-JACO Toll-Free
 440-234-7007 Fittings Fax
 www.jacomfg.com

45

FEMALE ELBOWS

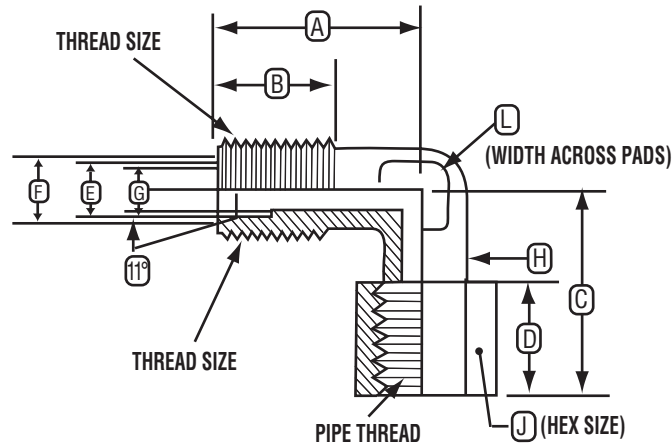
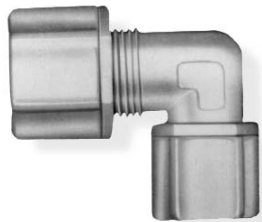

| JACO Part No. | LIST PRICE | | | | SPECIFICATIONS | | | | | | | | | | | | |
|------------------|----------------------|-------|------------------------------|-------|----------------|-----------|---------|---------|--------|---------|--------|------|-------------|--------|--------|--------|--------|
| | Standard Ferrule Nut | | Plastic or Steel Gripper Nut | | Tube O.D. | Pipe Thd. | Thread | A | B | C | D | E | F | G | H | J | I |
| | NYLON (N-O) | KYNAR | N-PG;SG | KYNAR | | | | ± 1/64 | ± 1/64 | ± 1/64 | ± 1/64 | .010 | | ± 1/64 | ± 1/64 | ± 1/64 | ± 1/64 |
| 45-2-4 | .97 | 2.73 | N/A | N/A | 1/8 | 1/4 | 5/16-24 | 51/64 | 7/16 | 31/32 | 11/16 | .125 | .175 - .180 | .109 | 23/64 | 43/64 | 23/64 |
| 45-4-2 | 1.00 | 2.89 | 1.14 | 3.00 | 1/4 | 1/8 | 7/16-20 | 13/16 | 15/32 | 3/4 | 1/2 | .250 | .330 - .335 | .170 | 3/8 | 9/16 | 3/8 |
| 45-4-4 | 1.02 | 3.05 | 1.16 | 3.16 | 1/4 | 1/4 | 7/16-20 | 13/16 | 15/32 | 31/32 | 43/64 | .250 | .330 - .335 | .170 | 3/8 | 51/64 | 3/8 |
| 45-5-4 | 1.17 | 3.33 | 1.28 | 3.46 | 5/16 | 1/4 | 1/2-20 | 15/16 | 31/64 | 1 | 11/16 | .312 | .380 - .385 | .232 | 7/16 | 25/32 | 7/16 |
| 45-6-4 | 1.23 | 4.39 | 1.39 | 4.44 | 3/8 | 1/4 | 5/8-20 | 1 | 19/32 | 1-1/64 | 11/16 | .375 | .460 - .465 | .250 | 9/16 | 13/16 | 9/16 |
| 45-6-6 | 1.40 | 4.50 | 1.55 | 4.55 | 3/8 | 3/8 | 5/8-20 | 15/16 | 19/32 | 1-1/32 | 11/16 | .375 | .460 - .465 | .250 | 9/16 | 13/16 | 9/16 |
| 45-8-6 | 1.63 | 5.59 | 1.81 | 5.64 | 1/2 | 3/8 | 3/4-20 | 1-1/16 | 11/16 | 1-1/64 | 13/16 | .500 | .590 - .595 | .375 | 11/16 | 29/32 | 45/64 |
| 45-8-8 | 1.90 | 5.92 | 2.08 | 5.97 | 1/2 | 1/2 | 3/4-20 | 1-1/16 | 11/16 | 1-21/64 | 13/16 | .500 | .590 - .595 | .375 | 11/16 | 29/32 | 45/64 |
| 45-10-8 | N/A | N/A | 2.66 | 6.86 | 5/8 | 1/2 | 7/8-20 | 1-25/64 | 45/64 | 1-1/16 | 1-1/16 | .625 | .715 - .720 | .500 | 13/16 | 1-1/16 | 13/16 |

N = NYLON C = CELCON (Acetal)
 P = POLYPROPYLENE
 K = KYNAR (Polyvinylidene Fluoride)

Sizes indicated are based on Celcon material (Acetal).

440-234-4000 Phone
800-229-JACO Toll-Free
440-234-7007 Fittings Fax
www.jacomfg.com

50

UNION & REDUCING ELBOWS

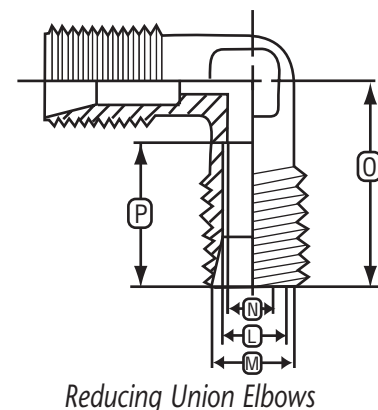
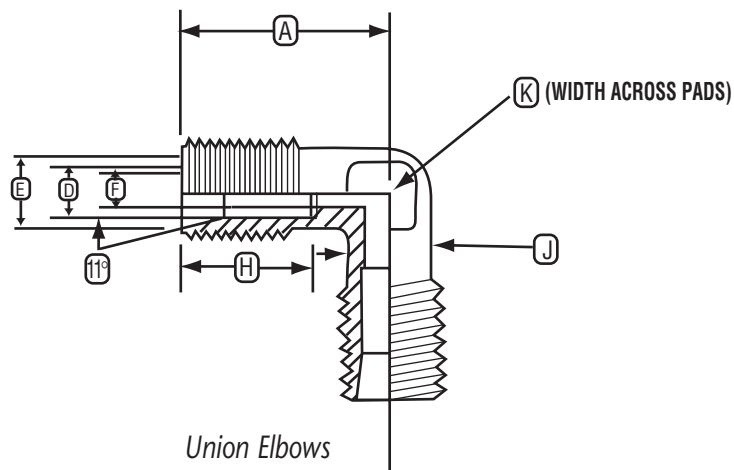

UNION ELBOWS

| JACO Part No. | LIST PRICE | | | |
|---------------|----------------------|-------|------------------------------|---------|
| | Standard Ferrule Nut | | Plastic or Steel Gripper Nut | |
| 50-4 | NYLON (N-O) | KYNAR | N-PG;SG | KYNAR |
| 50-5 | CELCON (C-O) | (K-O) | C-PG;SG | K-PG;SG |
| 50-6 | POLY (P-O) | | P-PG;SG | |
| 50-8 | 1.01 | 3.52 | 1.28 | 3.74 |
| 50-10 | 1.12 | 3.85 | 1.35 | 4.10 |
| 50-12 | 1.39 | 5.94 | 1.70 | 6.04 |
| 50-14 | 1.71 | 7.67 | 2.08 | 7.77 |
| | N/A | N/A | 3.47 | 9.38 |
| | N/A | N/A | 5.11 | 13.82 |
| | N/A | N/A | 5.80 | 17.09 |

| SPECIFICATIONS | | | | | | | | |
|----------------|-----------|---------|-----------------|--------------|--------|----------|--------|--------|
| Tube O.D. | Thread | A | D | E | F | H | J | K |
| | | ± 1/64 | +0.005/ .010 | | ± 1/64 | +/- 1/64 | ± 1/64 | ± 1/64 |
| 1/4 | 7/16-20 | 13/16 | .250 | .330 - .335 | .170 | 15/32 | 3/8 | 3/8 |
| 5/16 | 1/2-20 | 29/32 | .312 | .380 - .385 | .232 | 31/64 | 7/16 | 7/16 |
| 3/8 | 5/8-20 | 15/16 | .375 | .460 - .465 | .250 | 19/32 | 9/16 | 9/16 |
| 1/2 | 3/4-20 | 1-1/16 | .500 | .590 - .595 | .375 | 11/16 | 11/16 | 45/64 |
| 5/8 | 7/8-20 | 1-1/4 | .625 | .715 - .720 | .500 | 45/64 | 13/16 | 55/64 |
| 3/4 | 1-1/16 | 1-35/64 | .750 | .860 - .865 | .625 | 13/16 | 1 | 1 |
| 7/8 | 1-3/16-16 | 1-9/16 | .875 | .995 - 1.000 | .750 | 7/8 | 1-1/8 | 1-3/16 |

REDUCING UNION ELBOWS

| JACO Part No. | LIST PRICE | | | |
|---------------|----------------------|-------|------------------------------|---------|
| | Standard Ferrule Nut | | Plastic or Steel Gripper Nut | |
| 50-14-10 | NYLON (N-O) | KYNAR | N-PG;SG | KYNAR |
| | CELCON (C-O) | (K-O) | C-PG;SG | K-PG;SG |
| | POLY (P-O) | | P-PG;SG | |
| | N/A | N/A | 5.87 | 17.28 |

| SPECIFICATIONS | | | | | | | | | | | | | |
|----------------|--------------------|--------|-----------------|--------------|--------|--------|--------|--------|-----------------|-------------|-------|---------|--------|
| Tube O.D. | Thread | A | D | E | F | H | J | K | L | M | N | O | P |
| | | ± 1/64 | +0.005/ .010 | | ± 1/64 | ± 1/64 | ± 1/64 | ± 1/64 | +0.005/ .010 | | ±.010 | ± 1/64 | ± 1/64 |
| 7/8 - 5/8 | 1-3/16-20 - 7/8-20 | 1-9/16 | .875 | .995 - 1.000 | .750 | 7/8 | 1 1/8 | 1-3/16 | .625 | .715 - .720 | .500 | 1-29/64 | 45/64 |

N = NYLON C = CELCON (Acetal)
 P = POLYPROPYLENE
 K = KYNAR (Polyvinylidene Fluoride)

Sizes indicated are based on Celcon material (Acetal).

440-234-4000 Phone
 800-229-JACO Toll-Free
 440-234-7007 Fittings Fax
 www.jacomfg.com

60

MALE BRANCH TEES

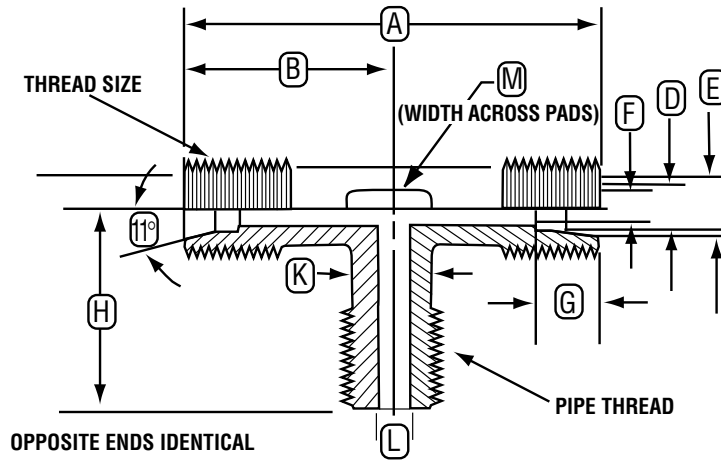

| JACO Part No. | LIST PRICE | | | | SPECIFICATIONS | | | | | | | | | | | | |
|---------------|---|----------------|---|------------------|----------------|--------------|-----------|---------|---------|------|--------------|------|-------|---------|--------|-------|--------|
| | Standard Ferrule Nut NYLON (N-O) CELCON (C-O) POLY (P-O) | KYNAR (K-O) | Plastic or Steel Gripper Nut N-PG;SG C-PG;SG P-PG;SG | KYNAR K-PG;SG | Tube O.D. | Pipe Thd. | Thread | A | B | D | E | F | G | H | K | L | M |
| 60-4-2 | 1.03 | 3.75 | 1.30 | 3.97 | 1/4 | 1/8 | 7/16-20 | 1-29/64 | 47/64 | .250 | .330 - .335 | .170 | 15/32 | 3/4 | 3/8 | 1/4 | 3/8 |
| 60-4-4 | 1.27 | 3.90 | 1.54 | 4.13 | 1/4 | 1/4 | 7/16-20 | 1-15/32 | 47/64 | .250 | .330 - .335 | .170 | 15/32 | 59/64 | 3/8 | 5/16 | 3/8 |
| 60-5-4 | 1.43 | 4.29 | 1.66 | 4.53 | 5/16 | 1/4 | 1/2-20 | 1-39/64 | 13/16 | .312 | .380 - .385 | .232 | 31/64 | 63/64 | 7/16 | 9/32 | 7/16 |
| 60-6-4 | 1.49 | 6.53 | 1.80 | 6.63 | 3/8 | 1/4 | 5/8-20 | 1-15/16 | 31/32 | .375 | .460 - .465 | .250 | 19/32 | 1-1/16 | 9/16 | 5/16 | 9/16 |
| 60-6-6 | 1.53 | 6.64 | 1.85 | 6.74 | 3/8 | 3/8 | 5/8-20 | 1-29/32 | 61/64 | .375 | .460 - .465 | .250 | 19/32 | 1-3/32 | 1/2 | 3/8 | 1/2 |
| 60-8-6 | 1.96 | 8.22 | 2.33 | 8.32 | 1/2 | 3/8 | 3/4-20 | 2-13/64 | 1-7/64 | .500 | .590 - .595 | .375 | 11/16 | 1-5/32 | 43/64 | 25/64 | 43/64 |
| 60-8-8 | 2.00 | 8.76 | 2.38 | 8.87 | 1/2 | 1/2 | 3/4-20 | 2-7/32 | 1-1/8 | .500 | .590 - .595 | .375 | 11/16 | 1-21/64 | 5/8 | 31/64 | 39/64 |
| 60-10-8 | N/A | N/A | 2.71 | 11.25 | 5/8 | 1/2 | 7/8-20 | 2-17/32 | 1-1/4 | .625 | .715 - .720 | .500 | 45/64 | 1-7/16 | 13/16 | 1/2 | 13/16 |
| 60-12-8 | N/A | N/A | 3.94 | 17.21 | 3/4 | 1/2 | 1-1/16-20 | 3-7/64 | 1-9/16 | .750 | .860 - .865 | .625 | 13/16 | 1-41/64 | 1-1/16 | 9/16 | 1-1/16 |
| 60-12-12 | N/A | N/A | 4.01 | 17.39 | 3/4 | 3/4 | 1-1/16-20 | 3-7/64 | 1-9/16 | .750 | .860 - .965 | .625 | 13/16 | 1-41/64 | 1-1/16 | 11/16 | 1-1/16 |
| 60-14-12 | N/A | N/A | 4.31 | 19.50 | 7/8 | 3/4 | 1-3/16-20 | 3-3/32 | 1-35/64 | .875 | .995 - 1.000 | .750 | 7/8 | 1-5/8 | 1-3/16 | 11/16 | 1-3/16 |

N = NYLON C = CELCON (Acetal)
 P = POLYPROPYLENE
 K = KYNAR (Polyvinylidene Fluoride)

Sizes indicated are based on Celcon material (Acetal).

440-234-4000 Phone
 800-229-JACO Toll-Free
 440-234-7007 Fittings Fax
 www.jacomfg.com

70

UNION TEES

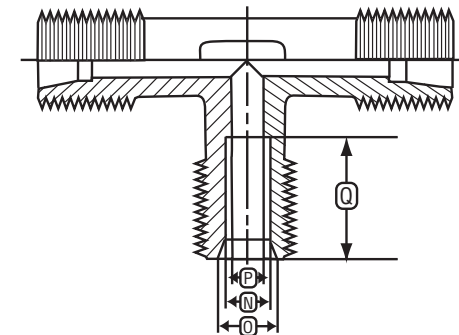
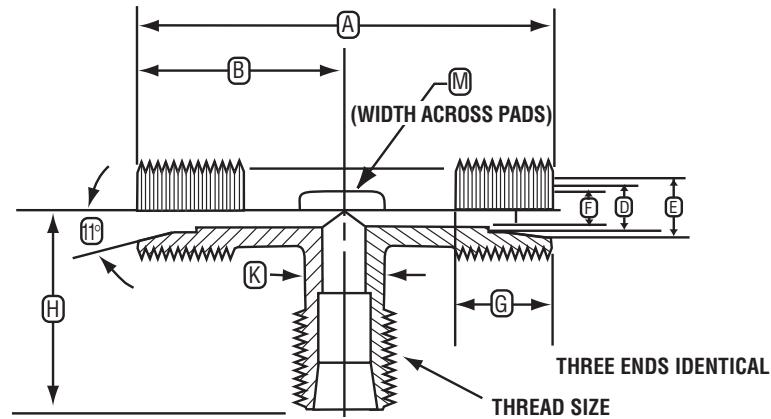
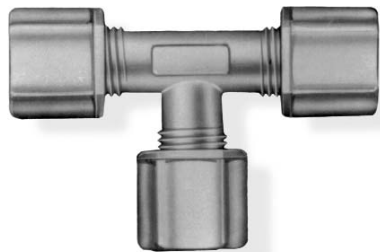

| JACO Part No. | LIST PRICE | | | |
|------------------|----------------------|-------|------------------------------|---------|
| | Standard Ferrule Nut | | Plastic or Steel Gripper Nut | |
| | NYLON (N-O) | KYNAR | N-PG;SG | KYNAR |
| | CELCON (C-O) | (K-O) | C-PG;SG | K-PG;SG |
| 70-2 | 1.11 | 3.85 | N/A | N/A |
| 70-4 | 1.27 | 4.65 | 1.68 | 4.99 |
| 70-5 | 1.41 | 5.21 | 1.75 | 5.58 |
| 70-6 | 1.75 | 8.35 | 2.22 | 8.50 |
| 70-8 | 2.11 | 10.41 | 2.67 | 10.56 |
| 70-10 | N/A | N/A | 2.90 | 13.73 |
| 70-12 | N/A | N/A | 4.97 | 24.79 |
| 70-14 | N/A | N/A | 5.28 | 27.51 |
| 70-10-6 | N/A | N/A | 2.76 | 13.11 |
| 70-14-10 | N/A | N/A | 5.88 | 28.90 |
| 70-14-10-10 | N/A | N/A | 6.15 | 31.64 |

| SPECIFICATIONS | | | | | | | | | | | | | | | |
|----------------|--------------------|------------|------------|--------------|--------------|------------|------------|------------|------------|------------|--------------|-------------|------------|------------|--|
| Tube O.D. | Thread | A | B | D | E | F | G | H | K | M | N | O | P | Q | |
| | | $\pm 1/64$ | $\pm 1/64$ | $+.005/.010$ | | $\pm 1/64$ | $\pm 1/64$ | $\pm 1/64$ | $\pm 1/64$ | $\pm 1/64$ | $+.005/.010$ | | $\pm .010$ | $\pm 1/64$ | |
| 1/8 | 5/16-24 | 1-1/8 | 9/16 | .125 | .175 - .180 | .109 | 7/16 | 17/32 | 1/4 | 1/4 | N/A | N/A | N/A | N/A | |
| 1/4 | 7/16-20 | 1-7/16 | 47/64 | .250 | .330 - .335 | .218 | 15/32 | 23/32 | 3/8 | 23/64 | N/A | N/A | N/A | N/A | |
| 5/16 | 1/2-20 | 1-19/32 | 13/16 | .312 | .380 - .385 | .232 | 31/64 | 13/16 | 7/16 | 29/64 | N/A | N/A | N/A | N/A | |
| 3/8 | 5/8-20 | 1-59/64 | 31/32 | .375 | .460 - .465 | .250 | 19/32 | 31/32 | 35/64 | 35/64 | N/A | N/A | N/A | N/A | |
| 1/2 | 3/4-20 | 2-1/8 | 1-1/16 | .500 | .590 - .595 | .375 | 11/16 | 1-1/16 | 43/64 | 11/16 | N/A | N/A | N/A | N/A | |
| 5/8 | 7/8-20 | 2-35/64 | 1-17/64 | .625 | .715 - .720 | .500 | 45/64 | 1-1/4 | 53/64 | 53/64 | N/A | N/A | N/A | N/A | |
| 3/4 | 1-1/16-20 | 3-3/32 | 1-35/64 | .750 | .860 - .865 | .625 | 13/16 | 1-35/64 | 1 | 1-1/16 | N/A | N/A | N/A | N/A | |
| 7/8 | 1-3/16-16 | 3-3/32 | 1-35/64 | .875 | .995 - 1.000 | .750 | 7/8 | 1-35/64 | 1-1/8 | 1-3/16 | N/A | N/A | N/A | N/A | |
| 5/8 - 3/8 | 7/8-20 - 5/8-20 | 2-17/32 | 1-17/64 | .625 | .715 - .720 | .500 | 45/64 | 1-9/64 | 13/16 | 13/16 | .375 | .460 - .465 | .250 | 19/32 | |
| 7/8 - 5/8 | 1-3/16-16 - 7/8-20 | 3-3/32 | 1-35/64 | .875 | .995 - 1.000 | .750 | 7/8 | 1-7/16 | 1-9/64 | 1-5/32 | .625 | .715 - .720 | .500 | 45/64 | |
| 7/8 - 5/8 | 1-3/16-16 - 7/8-20 | 3-1/64 | 1-29/64 | .875 | .995 - 1.000 | .500 | 7/8 | 1-7/16 | 1-9/64 | 1-5/32 | .625 | .715 - .720 | .500 | 45/64 | |

N = NYLON C = CELCON (Acetal)
P = POLYPROPYLENE
K = KYNAR (Polyvinylidene Fluoride)

Sizes indicated are based on Celcon material (Acetal).

440-234-4000 Phone
800-229-JACO Toll-Free
440-234-7007 Fittings Fax
www.jacomfg.com

75

MALE RUN TEES

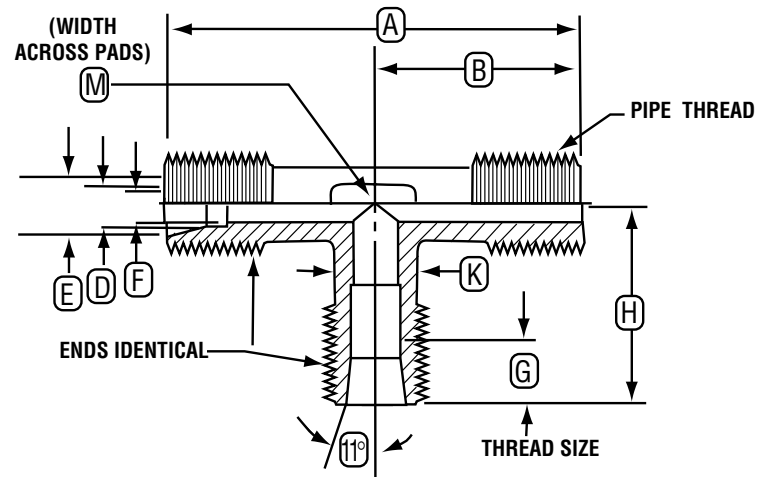
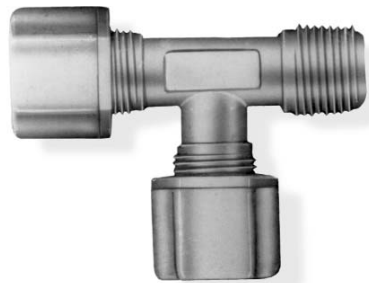

| JACO Part No. | LIST PRICE | | | |
|------------------|----------------------|-------|------------------------------|---------|
| | Standard Ferrule Nut | | Plastic or Steel Gripper Nut | |
| | NYLON (N-O) | KYNAR | N-PG;SG | KYNAR |
| | CELCON (C-O) | (K-O) | C-PG;SG | K-PG;SG |
| | POLY (P-O) | | P-PG;SG | |
| 75-4-2 | 1.03 | 3.75 | 1.30 | 3.97 |
| 75-4-4 | 1.27 | 3.90 | 1.54 | 4.13 |
| 75-5-4 | 1.43 | 4.31 | 1.66 | 4.55 |
| 75-6-4 | 1.49 | 6.53 | 1.80 | 6.63 |
| 75-6-6 | 1.53 | 6.65 | 1.85 | 6.75 |
| 75-8-6 | 1.96 | 8.22 | 2.33 | 8.32 |
| 75-8-8 | 2.00 | 8.76 | 2.38 | 8.87 |
| 75-10-8 | N/A | N/A | 2.71 | 11.25 |
| 75-12-8 | N/A | N/A | 3.97 | 17.21 |
| 75-12-12 | N/A | N/A | 3.99 | 17.39 |
| 75-14-12 | N/A | N/A | 4.31 | 19.50 |

| SPECIFICATIONS | | | | | | | | | | | |
|----------------|-----------|-----------|------------|------------|---------------------|--------------|------------|------------|------------|------------|------------|
| Tube O.D. | Pipe Thd. | Thread | A | B | D | E | F | G | H | K | M |
| | | | $\pm 1/64$ | $\pm 1/64$ | $\pm .005/$.010 | | $\pm .010$ | $\pm 1/64$ | $\pm 1/64$ | $\pm 1/64$ | $\pm 1/64$ |
| 1/4 | 1/8 | 7/16-20 | 1-15/32 | 3/4 | .250 | .330 - .335 | .170 | 15/32 | 47/64 | 3/8 | 23/64 |
| 1/4 | 1/4 | 7/16-20 | 1-21/32 | 15/16 | .250 | .330 - .335 | .170 | 15/32 | 47/64 | 3/8 | 3/8 |
| 5/16 | 1/4 | 1/2-20 | 1-3/16 | 1-1/64 | .312 | .380 - .385 | .232 | 31/64 | 13/16 | 7/16 | 7/16 |
| 3/8 | 1/4 | 5/8-20 | 2 | 1-3/64 | .375 | .460 - .465 | .250 | 19/32 | 31/32 | 35/64 | 35/64 |
| 3/8 | 3/8 | 5/8-20 | 2-1/8 | 1-3/32 | .375 | .460 - .465 | .250 | 19/32 | 31/32 | 37/64 | 37/64 |
| 1/2 | 3/8 | 3/4-20 | 2-1/4 | 1-9/64 | .500 | .590 - .595 | .375 | 11/16 | 1-7/64 | 11/16 | 11/16 |
| 1/2 | 1/2 | 3/4-20 | 2-3/8 | 1-9/32 | .500 | .590 - .595 | .375 | 11/16 | 1-3/32 | 21/32 | 43/64 |
| 5/8 | 1/2 | 7/8-20 | 2-47/64 | 1-15/32 | .625 | .715 - .720 | .500 | 45/64 | 1-1/4 | 13/16 | 13/16 |
| 3/4 | 1/2 | 1-1/16-20 | 3-3/16 | 1-39/64 | .750 | .860 - .865 | .625 | 13/16 | 1-37/64 | 1 | 1-3/64 |
| 3/4 | 3/4 | 1-1/16-20 | 3-3/16 | 1-5/8 | .750 | .860 - .865 | .625 | 13/16 | 1-9/16 | 1 | 1-3/64 |
| 7/8 | 3/4 | 1-3/16-16 | 3-3/16 | 1-5/8 | .875 | .995 - 1.000 | .750 | 7/8 | 1-9/16 | 1-1/8 | 1-3/16 |

N = NYLON C = CELCON (Acetal)
 P = POLYPROPYLENE
 K = KYNAR (Polyvinylidene Fluoride)

Sizes indicated are based on Celcon material (Acetal).

440-234-4000 Phone
 800-229-JACO Toll-Free
 440-234-7007 Fittings Fax
 www.jacomfg.com

COMPRESSION NUTS

Ferrule Nuts with Integral Sleeve

| JACO Part No. | LIST PRICE | | SPECIFICATIONS | | | | | |
|---------------|------------|-------------|----------------|-----------|--------------|--------------|---------|-------------------|
| | Nylon | Celcon Poly | KYNAR | Tube O.D. | A $\pm 1/64$ | B $\pm 1/64$ | C THD | D $+ .005 / .010$ |
| 0-2 | .21 | .74 | | 1/8 | 7/16 | 33/64 | 5/16-24 | .125 |
| 0-4 | .24 | .91 | | 1/4 | 5/8 | 5/8 | 7/16-20 | .250 |
| 0-5 | .29 | 1.02 | | 5/16 | 45/64 | 11/16 | 1/2-20 | .312 |
| 0-6 | .32 | 1.82 | | 3/8 | 13/16 | 47/64 | 5/8-20 | .375 |
| 0-8 | .40 | 2.20 | | 1/2 | 15/16 | 7/8 | 3/4-20 | .500 |



Plastic Gripper Nuts

| JACO Part No. | LIST PRICE | | SPECIFICATIONS | | | | | |
|---------------|------------|-------------|----------------|-----------|--------------|--------------|-----------|-------------------|
| | Nylon | Celcon Poly | KYNAR | Tube O.D. | A $\pm 1/64$ | B $\pm 1/64$ | C THD | D $+ .005 / .010$ |
| PG-4 | .38 | 1.02 | | 1/4 | 5/8 | 43/64 | 7/16-20 | .250 |
| PG-5 | .40 | 1.14 | | 5/16 | 11/16 | 47/64 | 1/2-20 | .312 |
| PG-6 | .47 | 1.87 | | 3/8 | 13/16 | 23/32 | 5/8-20 | .375 |
| PG-8 | .59 | 2.25 | | 1/2 | 15/16 | 7/8 | 3/4-20 | .500 |
| PG-10 | .64 | 3.03 | | 5/8 | 1-7/64 | 7/8 | 7/8-20 | .625 |
| PG-12 | 1.22 | 4.25 | | 3/4 | 1-5/16 | 1 | 1-1/16-20 | .750 |
| PG-14 | 1.34 | 4.88 | | 7/8 | 1-7/16 | 1-1/8 | 1-3/16-16 | .875 |

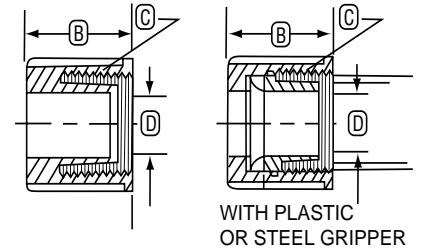
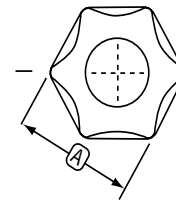

Stainless Steel Gripper Nuts

| JACO Part No. | LIST PRICE | | SPECIFICATIONS | | | | | |
|---------------|------------|-------------|----------------|-----------|--------------|--------------|-----------|-------------------|
| | Nylon | Celcon Poly | KYNAR | Tube O.D. | A $\pm 1/64$ | B $\pm 1/64$ | C THD | D $+ .005 / .010$ |
| SG-4 | .38 | 1.02 | | 1/4 | 5/8 | 43/64 | 7/16-20 | .250 |
| SG-5 | .40 | 1.14 | | 5/16 | 11/16 | 47/64 | 1/2-20 | .312 |
| SG-6 | .47 | 1.87 | | 3/8 | 13/16 | 23/32 | 5/8-20 | .375 |
| SG-8 | .59 | 2.25 | | 1/2 | 15/16 | 55/64 | 3/4-20 | .500 |
| SG-10 | .64 | 3.03 | | 5/8 | 1-1/8 | 7/8 | 7/8-20 | .625 |
| SG-12 | 1.22 | 4.25 | | 3/4 | 1-5/16 | 1 | 1-1/16-20 | .750 |
| SG-14 | 1.34 | 4.88 | | 7/8 | 1-7/16 | 1-1/8 | 1-3/16-16 | .875 |

N = NYLON C = CELCON (Acetal)
 P = POLYPROPYLENE
 K = KYNAR (Polyvinylidene Fluoride)

Sizes indicated are based on Celcon material (Acetal).

440-234-4000 Phone
 800-229-JACO Toll-Free
 440-234-7007 Fittings Fax
www.jacomfg.com

Inserts*

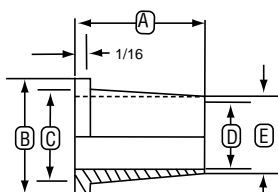

| JACO Part No. | LIST PRICE | | SPECIFICATIONS | | | | | |
|---------------|------------|-------|----------------|-------|-------------|-------------|------|------|
| | Nylon | KYNAR | Tube O.D. | A | B | C | D | E |
| P-4 | .09 | .16 | 1/4 | 3/8 | .240 - .250 | .199 | 1/8 | .167 |
| P-5 | .11 | .17 | 5/16 | 13/32 | .300 - .312 | .217 | 9/64 | .180 |
| P-6 | .13 | .19 | 3/8 | 1/2 | .360 - .370 | .245 - .250 | .200 | .235 |
| P-8 | .17 | .25 | 1/2 | 9/16 | .475 - .490 | .370 - .375 | .300 | .350 |

Blind Nuts

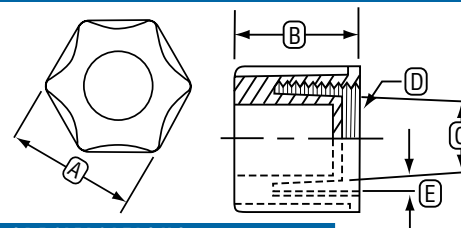

| JACO Part No. | LIST PRICE | | SPECIFICATIONS | | | | |
|---------------|------------|-------|----------------|-------|------|---------|----|
| | Nylon | KYNAR | A | B | C | D | E |
| 0-2 BLD | .26 | .86 | 7/16 | 33/64 | .170 | 5/16-24 | 3° |
| 0-4 BLD | .30 | 1.01 | 5/8 | 5/8 | .300 | 7/16-20 | 3° |
| 0-5 BLD | .34 | 1.13 | 11/16 | 11/16 | .370 | 1/2-20 | 3° |
| 0-6 BLD | .37 | 1.94 | 13/16 | 47/64 | .455 | 5/8-20 | 3° |
| 0-8 BLD | .46 | 2.31 | 15/16 | 7/8 | .575 | 3/4-20 | 3° |

*These items are offered in addition to our standard fitting product line. Standard discount schedule applies based upon total number of items ordered and are not subject to combined pricing with our standard fitting line.

Pipe * Nipples

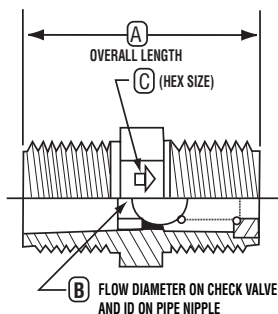

| JACO Part No. | LIST PRICE | | SPECIFICATIONS | | | |
|---------------|------------|-------|----------------|---------|-------|-------|
| | Celcon | KYNAR | Male Pipe NPT | A | B | C |
| PN-2 | .21 | 1.55 | 1/8 | 1 | 7/32 | 7/16 |
| PN-4 | .28 | 1.83 | 1/4 | 1-13/32 | 21/64 | 5/8 |
| PN-6 | .41 | 2.49 | 3/8 | 1-1/2 | 25/64 | 13/16 |
| PN-8 | .54 | 3.08 | 1/2 | 1-51/64 | 33/64 | 15/16 |

KYNAR Check Valves*

- Viton "O" Ring
- Stainless Ball & Spring
- Maximum Operating Temp. 220 P.S.I. @ 180° F
- Cracking Pressure 1-2.5 P.S.I.

- Zero Leakage
- Male Pipe NPT Style



| JACO Part No. | LIST PRICE | | SPECIFICATIONS | | | |
|---------------|------------|--|----------------|---------|-------|-------|
| | KYNAR | | Male Pipe NPT | A | B | C |
| CV-2 K | 8.73 | | 1/8 | 1 | 3/32 | 7/16 |
| CV-4 K | 9.29 | | 1/4 | 1-13/32 | 3/16 | 5/8 |
| CV-6 K | 9.90 | | 3/8 | 1-1/2 | 1/4 | 13/16 |
| CV-8 K | 11.17 | | 1/2 | 1-51/64 | 11/32 | 15/16 |

Bulkhead Nuts*

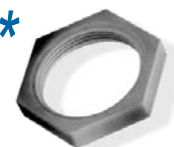

| JACO Part No. | LIST PRICE | |
|---------------|------------|-------|
| | Nylon | KYNAR |
| 0-4B | .16 | 1.02 |
| 0-5B | .18 | 1.03 |
| 0-6B | .19 | 1.15 |
| 0-8B | .26 | 1.28 |
| 0-12B | .29 | 1.41 |

N = NYLON C = CELCON (Acetal)
P = POLYPROPYLENE
K = KYNAR (Polyvinylidene Fluoride)

Sizes indicated are based on Celcon material (Acetal).

440-234-4000 Phone
800-229-JACO Toll-Free
440-234-7007 Fittings Fax
www.jacomfg.com

In-House Tooling and Manufacturing Ensure Quality.



A full complement of CNC and EDM machines ensure accuracy and quality during the mold manufacturing process.

JACO is the most unique fittings company in the industry because it engineers and designs its own fittings, constructs the tooling, and then molds the fittings — all in-house.

JACO's many years as a custom injection molder, designing and producing a wide range of precision, close tolerance parts, has provided the company with the expertise to develop high quality fittings and check valves. By having total control of all manufacturing aspects from design through production, JACO can also control the quality.

JACO's Engineering Group prepares fittings concepts into detailed engineering drawings. In JACO's Tooling Group, tooling experts use sophisticated

JACO's Tooling Group creates high precision molds used to manufacture JACO compression plastic tube fittings.

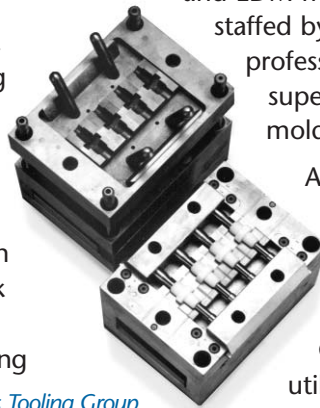

equipment to design and craft the most complex of molds. JACO has built many varieties of fitting molds and has gained expertise in the development of threaded parts. A full complement of CNC and EDM machines, staffed by a team of professionals, deliver superior quality molds.

After tooling, the work transfers to JACO's Molding Group, which utilizes more than 75 injection molding machines. Each day, thousands of fittings are molded to close tolerances with unflinching repeatability.

In order to consistently meet all customer requirements and continually increase customer satisfaction, JACO is commit-

ted to the continuous improvement of our products, our services, and our Quality Management System. This total commitment to Quality has enabled JACO to build and maintain a reputation of absolute trustworthiness. We are committed to providing the people and resources necessary to ensure the highest

quality parts. This goal is achievable with the assistance of JACO's highly trained Quality Assurance Team which accurately measures parts using precision gauges and instrumentation. With the company's various capabilities, it can continuously insure the quality and capability of JACO fittings.



JACO's Molding Group and Quality Assurance Group are dedicated to producing molded compression fittings with excellent repeatability and superior quality.

JACO is a Full Service Supplier of Injection Molded Plastics.

Custom Mold Capabilities

- Injection Molding
- Insert Molding
- Ten Ounce Shots
- Tight Tolerances
- ISO/TS 16949:2002
- ISO 9001:2000
- Engineering Support
- Tooling Design
- Tool Building
- SPC/Testing in House
- Part Design Support

JACO Manufacturing Company has been built on a reputation of customer service, practical applications experience and imaginative engineering. We manufacture high quality JACO compression tube fittings and a line of fittings for potable water systems.

JACO is also a specialist in the design and manufacture of close tolerance plastic parts. We consistently provide custom molded plastics into a variety of applications and industries. We are committed to meet and exceed our customer requirements for high quality, competitive parts and tooling.

To ensure top performance from all our products, we constantly provide a number of testing checks and quality control inspections. JACO's unique in-house capabilities are your assurance of quality parts, timely service and competitive pricing.

Contact JACO for more information on our wide range of products and services for the plastics industry.

Custom-Made Precision Plastic Parts



JACO specializes in small, close-tolerance plastic parts. We custom mold and insert mold parts up to 10 oz with unmatched repeatability, and offer a wide range of materials including high performance resins. JACO's in-house mold design, tooling and production ensure high quality.

JACO Custom Mold Inquiries

For inquiries and quotes on JACO custom molded products, please contact us:

440-234-4000 Phone

800-229-JACO Toll-Free

440-234-0610 Custom Mold Fax

www.jacomfg.com

Website

440-234-4000 Phone
800-229-JACO Toll-Free
440-234-7007 Fittings Fax
www.jacomfg.com

JACO

*Specializing in the manufacture
of small, close tolerance plastic parts*

JACO MANUFACTURING COMPANY
468 Geiger Street, P.O. Box 619
Berea, Ohio 44017 U.S.A.

440/234-4000
440/234-7007 FITTINGS FAX
Call Toll Free 1-800-229-JACO

© 2006 JACO MANUFACTURING COMPANY

www.jacomfg.com

